

LOC	DIST	REVISIONS				
		P	LTR	DESCRIPTION	DATE	DWN APVD
GP	00	M1		REVISED PER ECO-11-004835	11MAR11	RK HMR

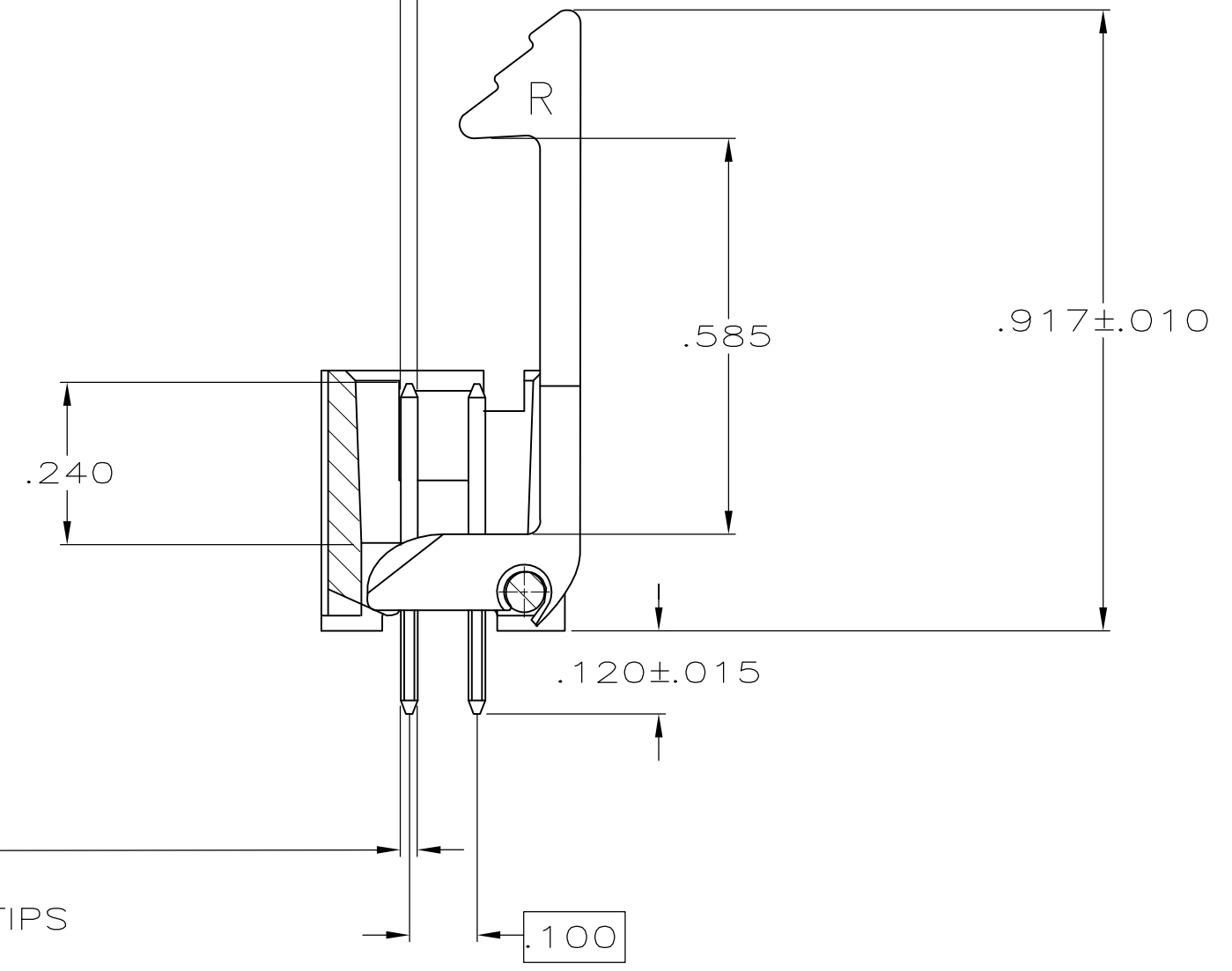

SECTION X-X
ROTATED 90° CW

- 1 THE NOTED DIMENSIONS APPLY AT THE INTERSECTION OF THE POST AND HOUSING
- 3 DOUBLE BAR POLARIZATION
- 4 CENTER POLARIZATION SLOT
- 5 FOR 10 POSN ASSEMBLY, SLOT OMITTED WHERE INDICATED
- 6 NUMBER 1 POSITION.
- OPTIONAL AMP IDENTIFICATION NUMBER (DATE CODE). LOCATION APPROXIMATELY WHERE SHOWN.
- MATERIAL: HOUSING: GLASS FILLED NYLON, FLAME RETARDANT, BLACK. POSTS: BRASS.
- POSTS: GOLD FLASH OVER PALLADIUM-NICKEL PLATE, .000030 MIN TOTAL ON THE MATING SUFACES, .000100 MIN TIN-LEAD PLATE ON THE SOLDER-TAILS, .000050 MIN NICKEL UNDERPLATE ON THE ENTIRE POST.
-OR-
.000030 MIN GOLD PLATE ON THE MATING SURFACES, .000100 MIN TIN-LEAD PLATE ON THE SOLDER-TAILS, .000050 MIN NICKEL UNDERPLATE ON THE ENTIRE POST.

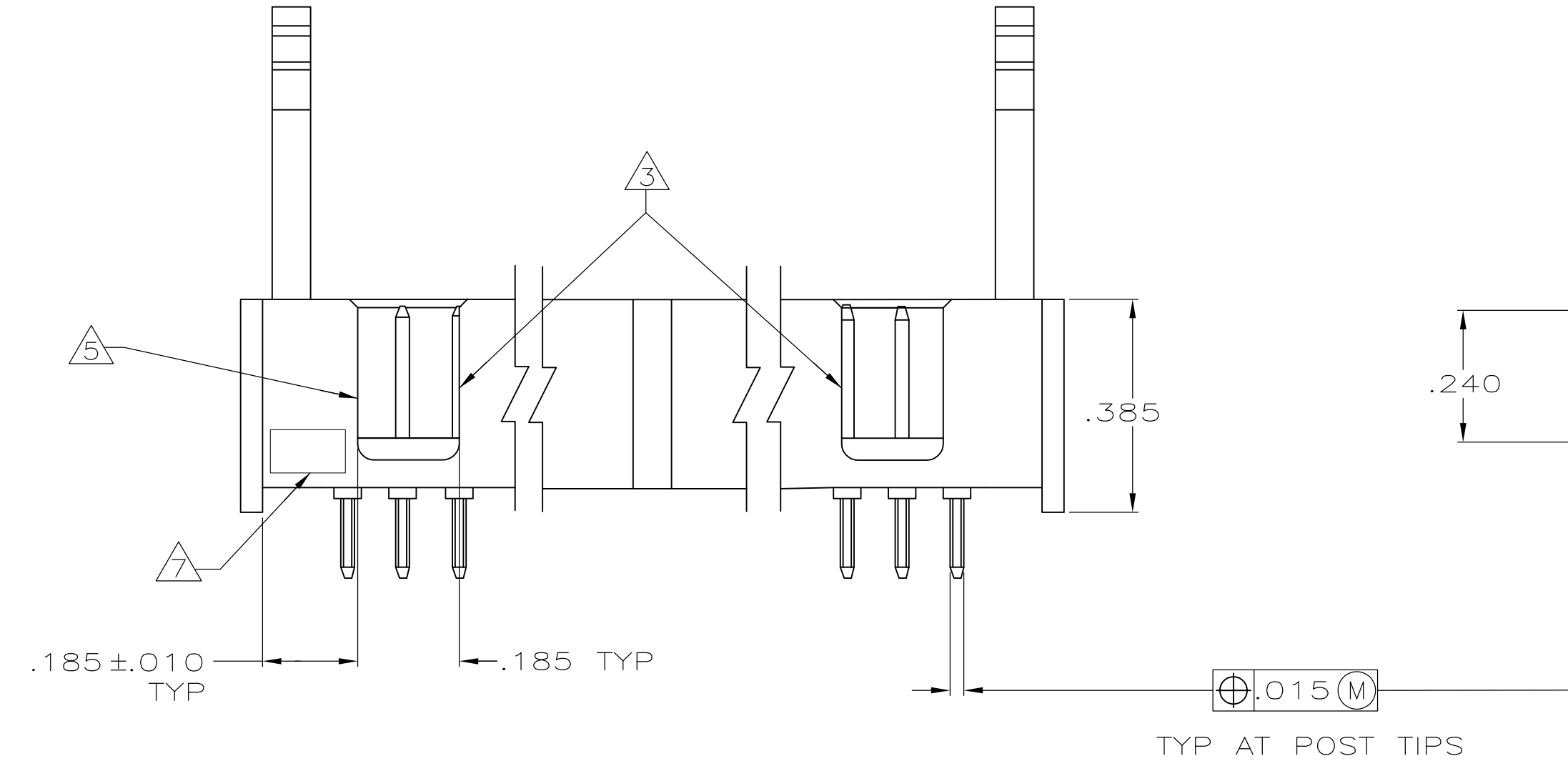
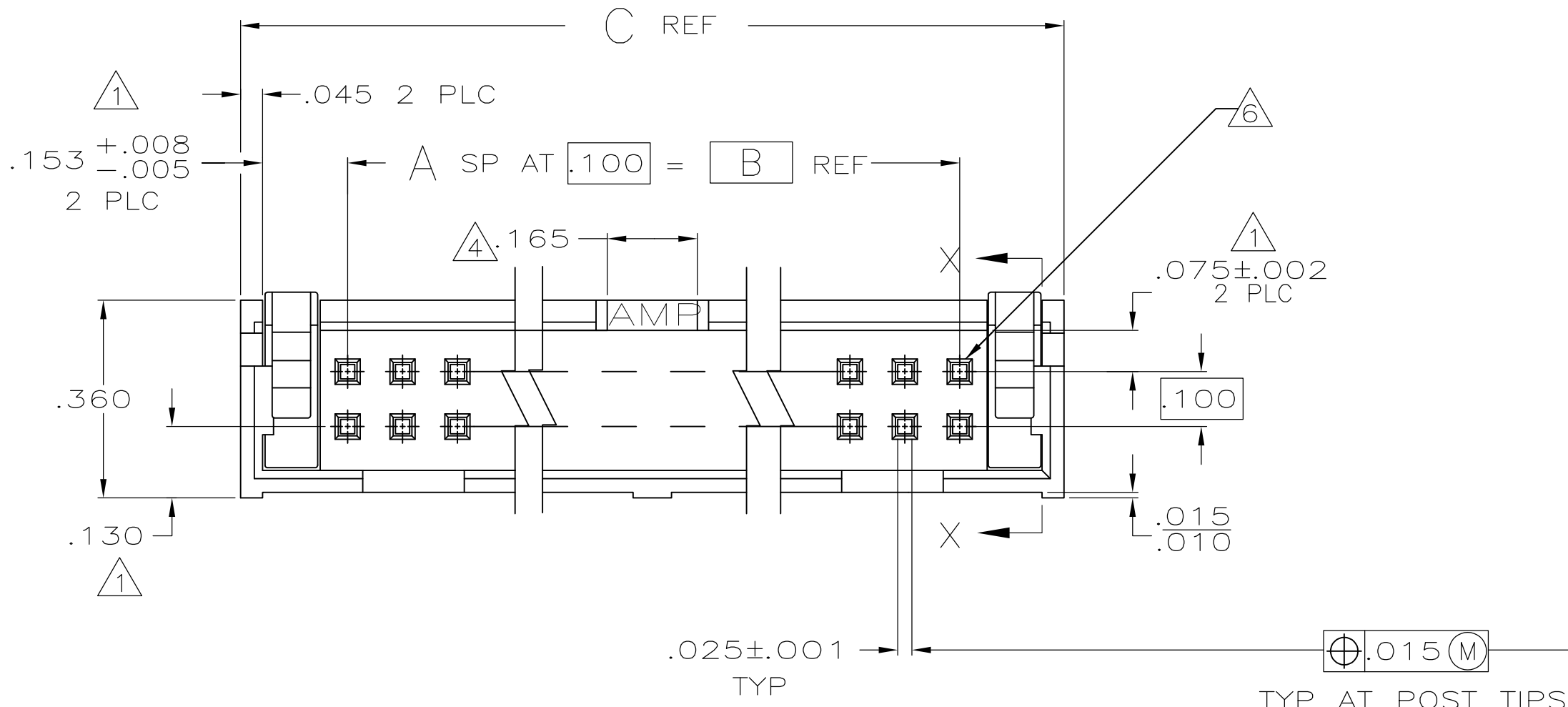
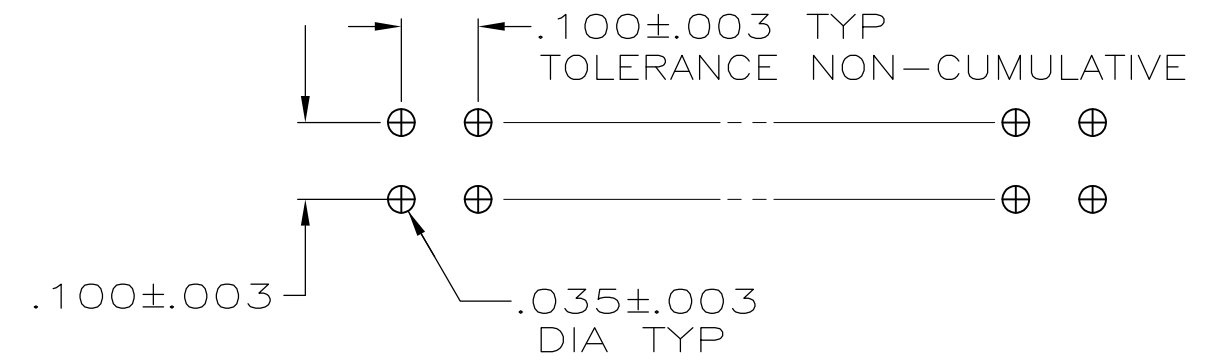

RECOMMENDED HOLE LAYOUT
FOR MANUAL INSERTION

	1.800	1.400	14	30	1-104128-2
OBSOLETE	1.500	1.100	11	24	1-104128-1
OBSOLETE	3.300	2.900	29	60	1-104128-0
	2.800	2.400	24	50	104128-9
OBSOLETE	2.500	2.100	21	44	104128-8
OBSOLETE	2.300	1.900	19	40	104128-7
	2.000	1.600	16	34	104128-6
	1.600	1.200	12	26	104128-5
	1.300	.900	9	20	104128-4
	1.100	.700	7	16	104128-3
	1.000	.600	6	14	104128-2
	.800	.400	4	10	104128-1
	C	B	A	NO OF POSN	ASSEMBLY PART NUMBER

THIS DRAWING IS A CONTROLLED DOCUMENT.

DIMENSIONS: INCHES

TOLERANCES UNLESS OTHERWISE SPECIFIED:
0 PLC ± -
1 PLC ± -
2 PLC ± -
3 PLC ± .005
4 PLC ± -
ANGLES ± -

MATERIAL

FINISH

DWN H. MOLL

CHK T. CLARK

APVD R. FLICKER

NAME

PRODUCT SPEC 108-40018

APPLICATION SPEC

SIZE A1

CAGE CODE 00779

DRAWING NO 104128

RESTRICTED TO

CUSTOMER DRAWING

SCALE 4:1

SHEET 1 OF 1

REV M1

TE Connectivity

HEADER ASSY, LOW PROFILE, AMP-LATCH

Mouser Electronics

Authorized Distributor

Click to View Pricing, Inventory, Delivery & Lifecycle Information:

[TE Connectivity:](#)

[104128-3](#)