



Collar screw, cross recess/slotted (M2.5x12.3), steel nickel plated



Catalog Number: 21101-101

[Back To Product](#)

- Collar screw
- For use of threaded inserts
- For assembly of partial width front panels
- For europacPRO and ratiopacPRO

Accessories:

Collar screw

Product family:

Front Panels

Product family:

- EuropacPRO
- PropacPRO
- CompacPRO
- RatiopacPRO
- Plug in units
- Frame Type Plug-In Units



Other Views

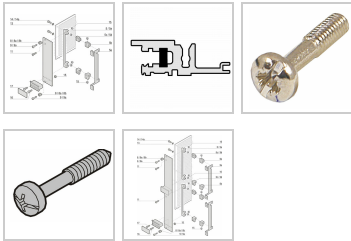

Select product specifications before modifying or adding to project list or requesting a quote.

Length mm

12.3

Quantity

100

Material

Nickel-plated Steel

[Clear Selection](#)

* Country / Region

United States

Quantity

1

Add Item to Project List +

Technical Data

Length mm	12.3
Material	St, nickel-plated
Dimension [mm]	M2.5 x 12.3
Material	St, nickel-plated
Finish	nickel-plated
Item	9a
Required number at 3 U	2
Required number at 6 U	2

Links



Native CAD files

Accessories

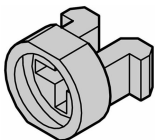

Sleeve, plastic, grey, PU 100 pcs

21100-464

Add Item to Project List +

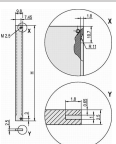

Sleeve, plastic, grey, PU 100 pcs

30846-865

Add Item to Project List +

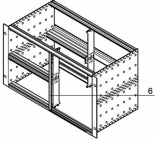

Sleeve, plastic, grey, PU 100 pcs

30847-472

[Add Item to Project List](#) +

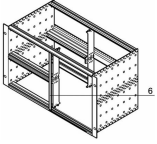

Front panel, U-Profile with notch, 6 H / 2 HP, 6 U, 2 HP, Al, 2.5 mm, U-profile with notch, 1 piece

30849-140

[Add Item to Project List](#) +

EXPLORE

- [About Us](#)
- [Services & Capabilities](#)
- [News & Events](#)
- [Newsletter Subscriptions](#)
- [Strategic Partnerships](#)
- [Investor Relations](#)
- [Virtual Patent Marking](#)

CONTACT

- [Customer Service](#)
- [Find a Sales Office or Distributor](#)
- [Global Locations](#)
- [Product Compliance & Certifications](#)
- [Partner Login](#)

DOWNLOAD

- [Download Center](#)
- [Reference Projects](#)
- [Videos](#)
- [Product Configurators](#)
- [Warranties and Terms of Sale & Procurement](#)

© 2020 nVent. All rights reserved | [Privacy Policy](#) | [Terms of Use](#) | [Site Map](#)

Connect With Us

