

PLUG
1292-P1 SHOWN

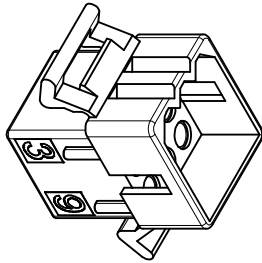

PLUG
1292-P2 SHOWN (WITH RIBS & PRESENT EARS)

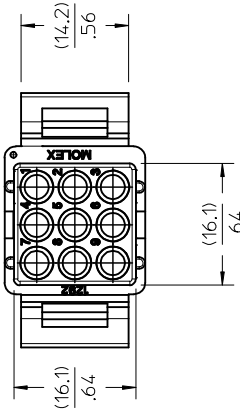
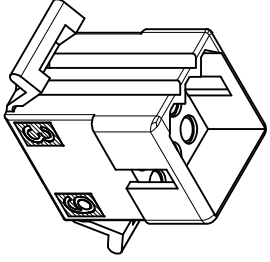
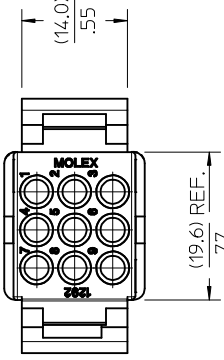

PLUG
1292-P SHOWN
(WITH BOTTOM MOUNT PRESENT EARS)

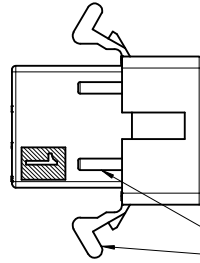
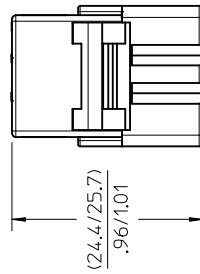
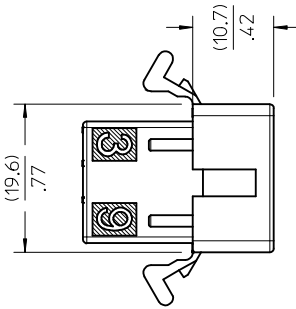

MOUNTING EARS AND RIBS OPTION (SEE DETAIL 1 & NOTE 6 ON SHEET 3)

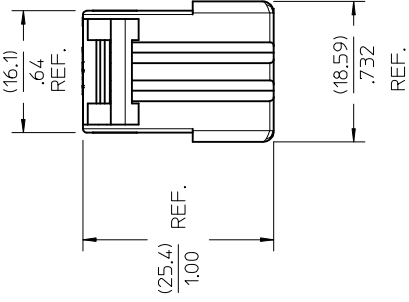

PRESENT MOUNTING EAR
SEE DETAIL 1 ON SHEET 3

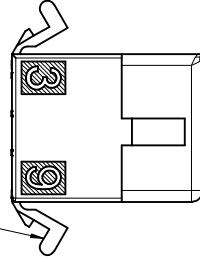

BOTTOM MOUNT PRESENT EAR OPTION

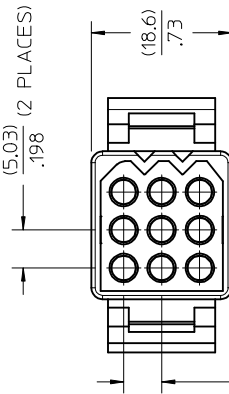

(5.03) .198 (2 PLACES)

| QUALITY SYMBOLS | | GENERAL TOLERANCES (UNLESS SPECIFIED) | | DIMENSION STYLE | | SCALE | | DESIGN UNITS | | THIRD ANGLE PROJECTION | |
|--|-------------|---------------------------------------|--------|-----------------|------------|---|-----|--------------|------|------------------------|------|
| SYMBOL | DESCRIPTION | MM | INCH | MM/IN | DATE | TITLE | 2:1 | INCH | INCH | INCH | INCH |
| | 4 PLACES | ± .010 | ± .010 | MM/IN | 2011/07/21 | .093/(2.36) HOUSING, PLUG 9 CKT. .198/(5.03) CTRS | | | | | |
| | 3 PLACES | ± .014 | ± .014 | | | | | | | | |
| | 2 PLACES | ± .025 | ± .025 | | | | | | | | |
| | 1 PLACE | ± 0.35 | ± .035 | | | | | | | | |
| | ANGULAR | ± 1/2° | ± 1/2° | | | | | | | | |
| DRAFT WHERE APPLICABLE MUST REMAIN WITHIN DIMENSIONS | | | | | | | | | | | |
| SEE CHART | | | | | | | | | | | |
| MATERIAL NO. DOCUMENT NO. | | | | | | | | | | | |
| SD-1292-0001 | | | | | | | | | | | |
| SHEET NO. 1 OF 3 | | | | | | | | | | | |
| INCORPORATED AND SHOULD NOT BE USED WITHOUT WRITTEN PERMISSION | | | | | | | | | | | |
| MATERIAL NO. DOCUMENT NO. | | | | | | | | | | | |
| SD-1292-0001 | | | | | | | | | | | |
| SHEET NO. 1 OF 3 | | | | | | | | | | | |
| INCORPORATED AND SHOULD NOT BE USED WITHOUT WRITTEN PERMISSION | | | | | | | | | | | |

| REV | DESCRIPTION | DATE | APP'D | CHK'D |
|-----|---------------------|------------|--------------|------------|
| M | ADD SHEETS 2-3 | 2014/01/27 | DRWN:MK1PPER | 2014/01/27 |
| | FC NO: UCP2014-3075 | | | |
| | APP:FSM1TH | 2014/02/14 | | |
| | CHKD:JBELT | 2014/01/27 | | |

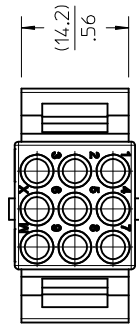

OPTIONAL MOUNTING EARS
SEE DETAIL 1 ON SHEET 3

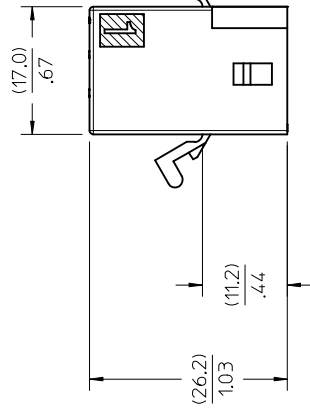

OPTIONAL
LOCK RAMP

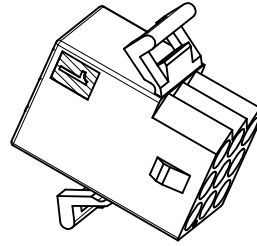
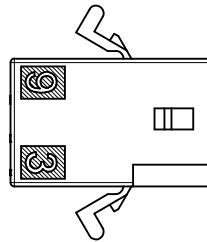
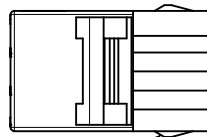

RECEPTACLE
1292-R SHOWN

(WITH PREBENT MOUNTING EARS & LOCK RAMPS)

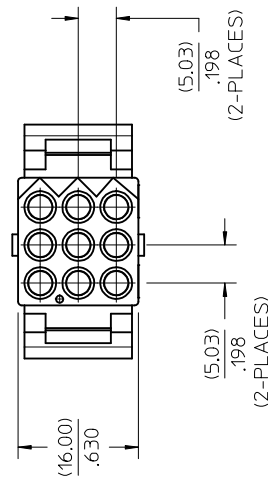

| QUALITY SYMBOLS | GENERAL TOLERANCES (UNLESS SPECIFIED) | DIMENSION STYLE | SCALE | DESIGN UNITS | THIRD ANGLE PROJECTION |
|--|---|--|-------|--------------|------------------------|
| $\nabla = 0$ $\nabla = 0$ $\nabla = 0$ | 4 PLACES ± .010 3 PLACES ± .014 2 PLACES ± 0.25 1 PLACE ± 0.35 ANGULAR ± 1/2° | MM/IN DATE: 2011/07/21 DRAWN BY: C STEWART CHECKED BY: _____ DATE: _____ APPROVED BY: _____ DATE: 2011/09/12 FSM: ITH | 2:1 | INCH | |
| TITLE: .093/(2.36) HOUSING, PLUG 9 CKT. .198/(5.03) CTRS | | | | | |
| MATERIAL NO. MOLEX INCORPORATED DOCUMENT NO. SD-1292-0001 SHEET NO. 2 OF 3 | | | | | |
| DRAFT WHERE APPLICABLE MUST REMAIN WITHIN DIMENSIONS | | | | | |
| SIZE THIS DRAWING CONTAINS INFORMATION THAT IS PROPRIETARY TO MOLEX INCORPORATED AND SHOULD NOT BE USED WITHOUT WRITTEN PERMISSION | | | | | |

| REV | DESCRIPTION |
|-------------|---|
| M | EC NO: UCP2014-3075 DRWN:MK/PPER CHKD:JBE/LL APP:FSM/ITH 2014/02/14 |
| SEE SHEET 1 | |

| PLUG | | RECEPTACLE | |
|------------|-----------|------------|-----------|
| PART NO. | ENG. NO. | PART NO. | ENG. NO. |
| 03-09-2091 | 1292-P | 03-09-1091 | 1292-R |
| 03-09-2092 | 1292-P1 | 03-09-1092 | 1292-R1 |
| 03-09-7091 | 1292-PBK | 03-09-6091 | 1292-RBK |
| 03-09-7092 | 1292-P1BK | 03-09-6092 | 1292-R1BK |
| NOT TOOLED | 1292-P2 | 03-09-1093 | 1292-R2 |
| 27-09-2092 | 1292-P1-A | 03-09-6093 | 1292-R2BK |
| | | 03-09-1094 | 1292-R3 |
| | | 03-09-6094 | 1292-R3BK |
| | | 27-09-1093 | 1292-R2-A |

| PLUG | | RECEPTACLE | |
|------------|-----------|------------|-----------|
| PART NO. | ENG. NO. | PART NO. | ENG. NO. |
| 03-09-2091 | 1292-P | 03-09-1091 | 1292-R |
| 03-09-2092 | 1292-P1 | 03-09-1092 | 1292-R1 |
| 03-09-7091 | 1292-PBK | 03-09-6091 | 1292-RBK |
| 03-09-7092 | 1292-P1BK | 03-09-6092 | 1292-R1BK |
| NOT TOOLED | 1292-P2 | 03-09-1093 | 1292-R2 |
| 27-09-2092 | 1292-P1-A | 03-09-6093 | 1292-R2BK |
| | | 03-09-1094 | 1292-R3 |
| | | 03-09-6094 | 1292-R3BK |
| | | 27-09-1093 | 1292-R2-A |

| PLUG | | RECEPTACLE | |
|------------|-----------|------------|-----------|
| PART NO. | ENG. NO. | PART NO. | ENG. NO. |
| 03-09-2091 | 1292-P | 03-09-1091 | 1292-R |
| 03-09-2092 | 1292-P1 | 03-09-1092 | 1292-R1 |
| 03-09-7091 | 1292-PBK | 03-09-6091 | 1292-RBK |
| 03-09-7092 | 1292-P1BK | 03-09-6092 | 1292-R1BK |
| NOT TOOLED | 1292-P2 | 03-09-1093 | 1292-R2 |
| 27-09-2092 | 1292-P1-A | 03-09-6093 | 1292-R2BK |
| | | 03-09-1094 | 1292-R3 |
| | | 03-09-6094 | 1292-R3BK |
| | | 27-09-1093 | 1292-R2-A |

| PLUG | | RECEPTACLE | |
|------------|-----------|------------|-----------|
| PART NO. | ENG. NO. | PART NO. | ENG. NO. |
| 03-09-2091 | 1292-P | 03-09-1091 | 1292-R |
| 03-09-2092 | 1292-P1 | 03-09-1092 | 1292-R1 |
| 03-09-7091 | 1292-PBK | 03-09-6091 | 1292-RBK |
| 03-09-7092 | 1292-P1BK | 03-09-6092 | 1292-R1BK |
| NOT TOOLED | 1292-P2 | 03-09-1093 | 1292-R2 |
| 27-09-2092 | 1292-P1-A | 03-09-6093 | 1292-R2BK |
| | | 03-09-1094 | 1292-R3 |
| | | 03-09-6094 | 1292-R3BK |
| | | 27-09-1093 | 1292-R2-A |

LEGEND: PLUG
 1292-P * * * * *
 P = PLUG

BLANK = WITH PREBENT BOTTOM MOUNT EARS
 1 = WITHOUT EARS
 2 = PLUG WITH PREBENT EARS & RIBS

COLOR: BLANK=NATURAL COLOR
 AM=AMBER BK=BLACK BU=BLUE
 BN=BROWN GY=GRAY GN=GREEN
 OR=ORANGE RD=RED YW=YELLOW

MATERIAL: BLANK = NYLON 6/6, U.L. 94V-2
 A = NYLON 6/6, U.L. 94V-0

LEGEND: RECEPTACLE
 1292-R * * * * *
 R = RECEPTACLE

BLANK = WITH PREBENT EARS, WITH LOCK RAMPS
 1 = WITH PREBENT EARS, WITHOUT LOCK RAMPS
 2 = WITHOUT EARS, WITHOUT LOCK RAMPS
 3 = WITHOUT EARS, WITH LOCK RAMPS

COLOR: BLANK=NATURAL COLOR
 AM=AMBER BK=BLACK BU=BLUE
 BN=BROWN GY=GRAY GN=GREEN
 OR=ORANGE RD=RED YW=YELLOW

MATERIAL: BLANK = NYLON 6/6, U.L. 94V-2
 A = NYLON 6/6, U.L. 94V-0

| HOUSING | DIM. "A" | DIM. "B" | DIM. "C" |
|-------------------|--------------|--------------|------------|
| STD. PLUG | (23.62)/.930 | (19.30)/.760 | (9.91)/.39 |
| BOTTOM MOUNT PLUG | (23.80)/.937 | (16.76)/.660 | (4.1)/.16 |
| RECEPTACLE | (21.03)/.828 | (18.42)/.725 | (10.4)/.41 |

NOTES:
 1. MATERIAL: SEE LEGEND
 2. FINISH: N/A
 3. THESE PARTS COMPLY WITH MOLEX PRODUCT SPEC. PS-02-09.
 4. PACKAGING: PK-1292-001
 5. HOUSINGS FOR USE WITH MOLEX .093/(2.36) PIN AND SOCKET TERMINALS.
 6. RIBS ARE PRESENT ONLY ON PLUG 1292-P2.

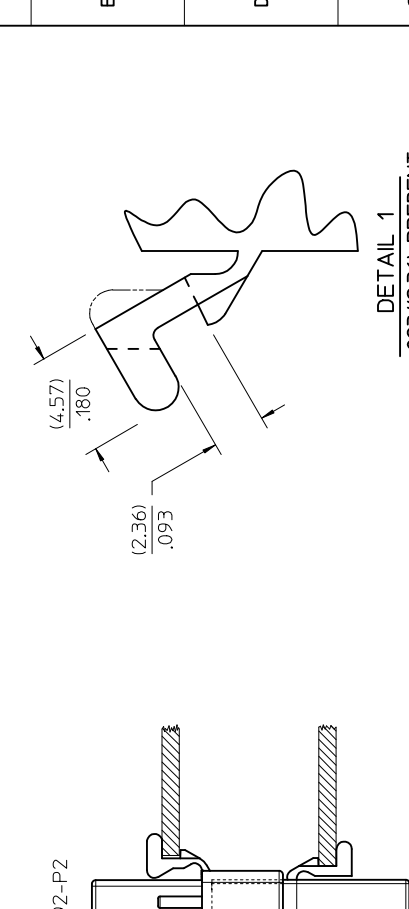
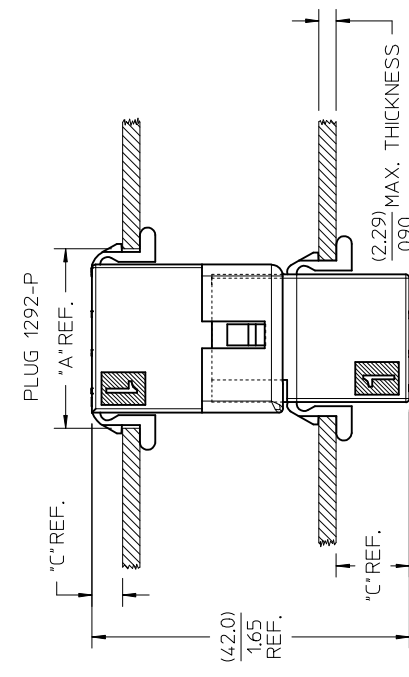

| QUALITY SYMBOLS | GENERAL TOLERANCES (UNLESS SPECIFIED) | DIMENSION STYLE | SCALE | DESIGN UNITS | THIRD ANGLE PROJECTION |
|-----------------|--|---|---|--------------|------------------------|
| ▽=0 | 4 PLACES ±.0005 | MM/IN | 2:1 | INCH | ☉ |
| ▽=0 | 3 PLACES ±.014 | DRAWN BY | TITLE | | |
| ▽=0 | 2 PLACES ±0.25 | DATE | .093/(2.36) HOUSING, PLUG 9 CKT. .198/(5.03) CTRS | | |
| | 0 PLACE ± | CSTEWART | | | |
| | ANGULAR ±1/2° | CHECKED BY | | | |
| | DRAFT WHERE APPLICABLE MUST REMAIN WITHIN DIMENSIONS | DATE | | | |
| | | FSMITH | | | |
| | | APPROVED BY | | | |
| | | DATE | | | |
| | | 2011/09/12 | | | |
| | | MATERIAL NO. | | | |
| | | SEE CHART | | | |
| | | SD-1292-0001 | | | |
| | | DOCUMENT NO. | | | |
| | | 3 OF 3 | | | |
| | | THIS DRAWING CONTAINS INFORMATION THAT IS PROPRIETARY TO MOLEX INCORPORATED AND SHOULD NOT BE USED WITHOUT WRITTEN PERMISSION | | | |

