



Z-PACK 2mm HM Connectors (Continued)

Male Cable Connector Shrouds

Zero Insertion Force (ZIF)

Cable Shrouds

ZIF shrouds are used with 5 row and 5+2 row feed-through male connectors to allow cables to be connected to the rear of the backplane.

Separate variable thickness spacers are available (see page 225) to compensate for a range of backplane thicknesses. Spacers are assembled to shrouds before fitting over pins, and then pressed down using a male insertion tool.

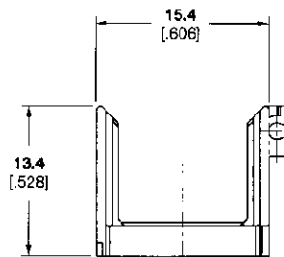

Material

Shroud and Snap Latch:

- Glass filled polyester, gray; rating, UL94V-0

Type	Part Number	Dim A Length (mm)
A or B	352601-2	49.90 [1.96]
B (22)	352672-2	43.90 [1.73]
B (19)	352673-2	37.90 [1.49]
B (11)	352674-2	21.90 [0.86]

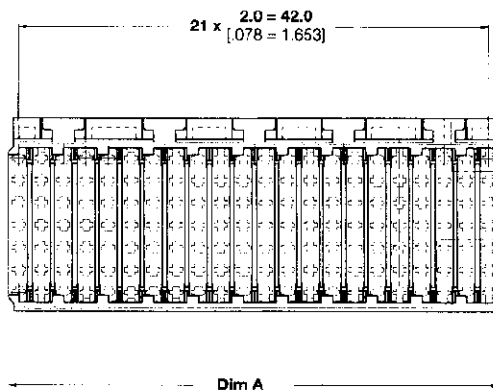

Latches

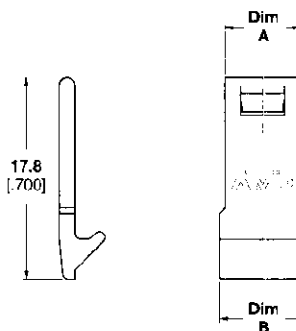

Positions	Part Number	Dim. A Length	Dim. B Length
4	352706-2	7.8 [0.29]	6.8 [0.26]
5	352706-1	9.8 [0.38]	8.8 [0.34]